

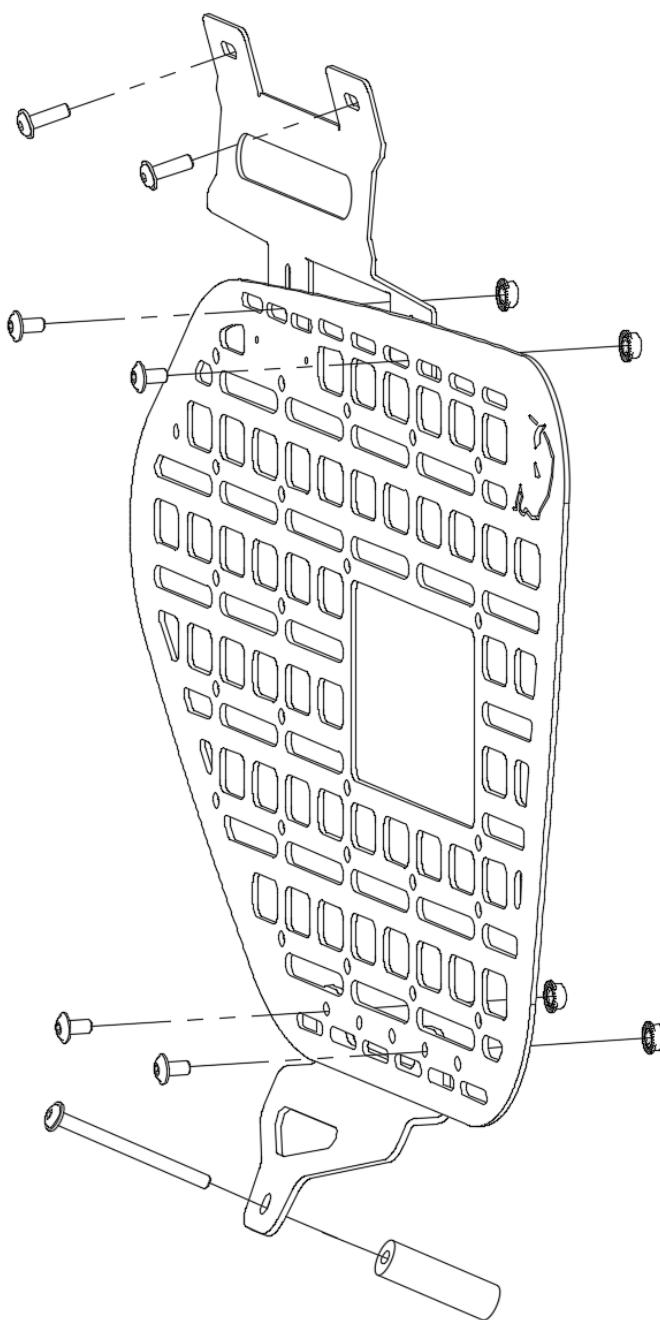

EN

Land Cruiser 150 / GX 460 Internal MOLLE Panel installation guide





1. Remove grab handle in the trunk
 - a. Open plastic cups
 - b. Unscrew bolts using 10 mm socket or philips screwdriver.



2. Remove plastic cover under the trunk window.



3. Unscrew bolt, using 10 mm socket or philips screwdriver.





4. Use a long bolt and spacer to attach a lower bracket to the car.



5. Use M6x20 bolts to attach the upper bracket.





6. Use two M6x12 bolts and the nuts to attach the panel to the top bracket.



7. Use two M6x12 bolts to attach the panel to the bottom bracket.





8. Adjust the panel and tighten all bolts.



In case of any questions please contact our customer support at

contact@bison-gear.com